

Installation and operating instruction

eLight - Outdoor light / socket

Models: White/Color - S/L – Single/Double/Triple

Version: 08.2023





hesotec electrify gmbh
Rubbertskaath 34
46539 Dinslaken / GER

HR - Nr. HRB 31112 AG Duisburg
St. - Nr. 101 / 5707 / 2333
UID - Nr. DE320783037

Phone +49(0) 2064 / 60 105 - 60
Fax +49(0) 2064 / 60 105 - 50

Web electrify.hesotec.de
E-Mail electrify@hesotec.de

Contents

1	Important Information and safety instructions	1
1.1	Foreword.....	1
1.2	General safety instructions	1
1.3	Safety instructions in this manual	2
2	Product overview and dimensions.....	3
2.1	Type plate	3
2.2	eLight Models	3
2.3	Ground anchor (Art.-No.00010276)	4
2.4	Technical Data	5
3	Installation	5
3.1	Demands on Location of eLight	6
3.2	Assembly of eLight	7
3.2.1	Assembly with ground anchor	7
3.2.2	Assembly on an alternative Ground	8
3.3	Electrical Installation of the eLight	10
3.3.1	Connection description eLight variants	11
3.3.2	Electrical Installation of the Outdoor light / socket.....	12
4	Operation	13
5	Change illuminant.....	14
6	Repair work.....	15
7	Maintenance / Disposal	16
7.1	Maintenance	16
7.2	Disposal	16
8	Appendix.....	17
8.1	CE-Label and Declaration of Conformity	17

1 Important Information and safety instructions

1.1 Foreword

We are pleased that you have chosen the eLight outdoor light / socket from hesotec electrify.

With the electrify eLight you invest in an innovative technology, combined with a sophisticated design and robust compactness.

The eLight complies with all existing safety guidelines and standards.

Read these installation and operating instructions completely before you start with the installation and commissioning. Keep this manual for future reference.

1.2 General safety instructions

To ensure proper installation and safe operation, follow the safety instructions given in this manual. Improper handling or non-compliance with the safety instructions may result in damage to the device itself, serious injury, fire or death. It is also advisable that every user of the eLight has access to content-related aspects about operation and in particular to safety instructions.

The installation, commissioning and maintenance of the electrify eLight may only be carried out by a qualified electrician. The operation of the eLight may only be carried out after a technically perfect installation with subsequent acceptance. Faults and repairs that lead to damage to persons, to the device itself or other consumers may only be carried out by qualified specialist personnel.

In case of malfunctions and malfunctions due to a faulty installation, first contact the company that carried out the installation. If the problem persists, contact the hesotec electrify hotline.

Telefon +49(0) 2064 / 60 105 – 60

Mail electrify@hesotec.de



hesotec electrify assumes no liability for the following cases in the event of personal injury or property damage:

- Disregard of the installation and operating instructions
- Installation of unqualified technical personnel
- Structural alterations to the outdoor light / socket
- Improper handling
- Use of unauthorized spare parts or accessories

1.3 Safety instructions in this manual

This manual contains essential information for the installation and commissioning of the eLight of hesotec electrify. The following safety instructions are essential to be read and followed

The warnings contained in this installation and operating manual must be observed with great care. The meaning of the individual markings is described below:

Mark	Meaning
	<p>DANGER !</p> <p>Safety note on a hazard with electrical voltage</p> <p>Non-observance of the instructions may result in electrical damage to the device itself, serious injury, and death.</p>
	<p>ATTENTION !</p> <p>Safety information on a hazard</p> <p>Non-observance of the instructions may result in damage to the device itself or other consumers. Execution with special care!</p>
	<p>NOTE !</p> <p>Important information and special features</p> <p>For a successful operation, the instructions should be carried out as needed.</p>

2 Product overview and dimensions

In this chapter you will get an overview of product information with the necessary dimensions for the optimal planning and preparation.

2.1 Type plate



Information on the type plate:

- Manufacturer
- Series
- Model
- Power
- Serial number
- Manufacturing
- Rated current
- Nominal voltage
- Nominal frequency
- Power supply
- Protection class

2.2 eLight Models

The purchased electrify eLight is already fully assembled and delivered after successful quality control. It is only a secured supply line between the house sub-distribution and the outdoor light / socket needed. The respective requirements for the power connection can be found in the technical data.

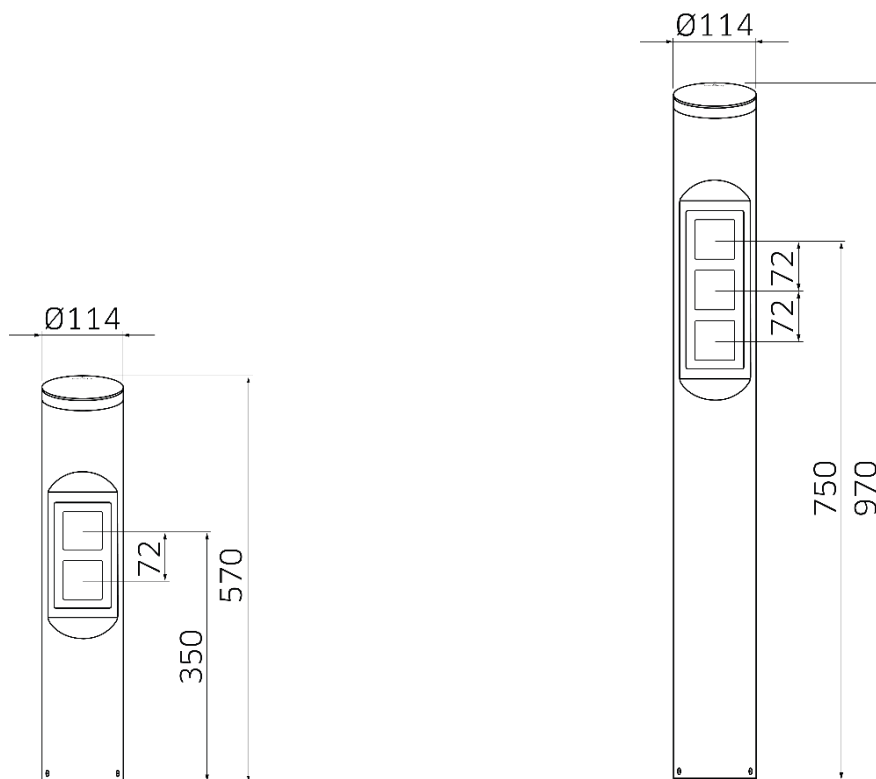

Dimensions on the example, left: eLight S Double Model; right: eLight L Triple Model (measurement unit mm)

2.3 Ground anchor (Art.-No.00010276)

For mounting the eLight, hesotec electrify recommends the ground anchor included in the scope of delivery, which is inserted into the ground or alternatively poured into concrete. The prefabricated screw connection points make it easier to install the eLight.

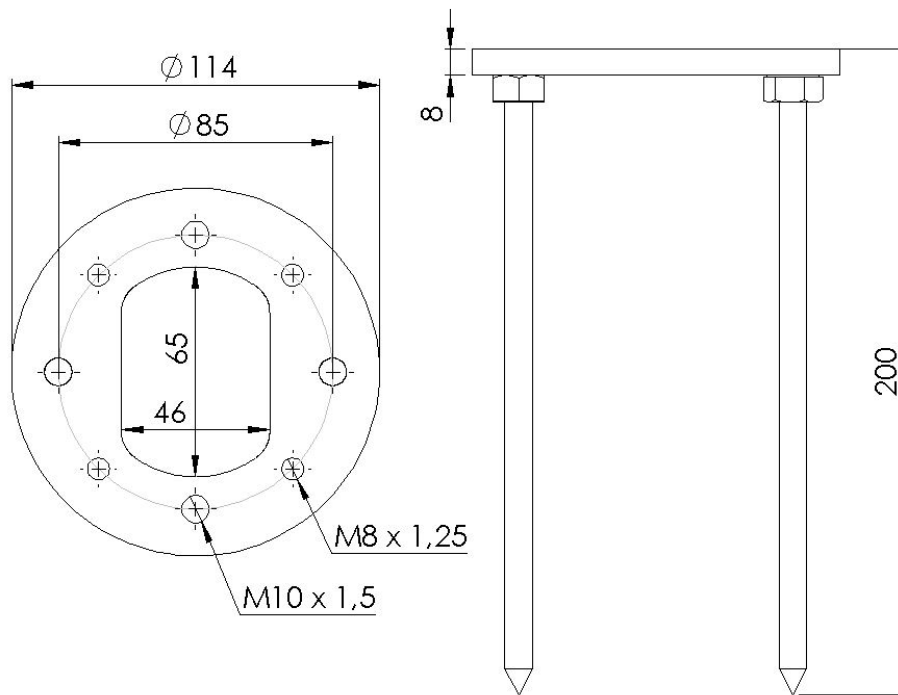

Top and side view of ground anchor (measuring unit mm)

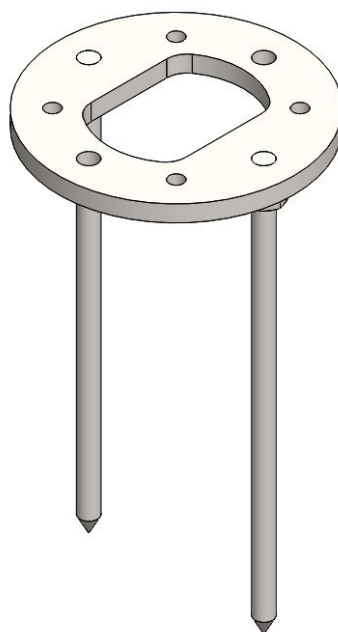

Three-dimensional view of ground anchor

2.4 Technical Data

General technical details eLight series

Supply voltage	230 V
Rated current	max. 16 A
Connection type	Push-in connection
Wire cross section	0.14 mm ² – 4 mm ²
Wire cross section with ferrule	0.14 mm ² – 2.5 mm ²
Connection options	Separate connection of sockets and lighting possible by removing the jumpers
Protective class	1
Socket	E27 max. 4/250
Illuminant	depending on version (60x110 mm)
Energy efficiency class	F
Number of sockets	depending on version (0 to 3 pcs.)
Theft protection	Safety screws
Operating temperature	-20 °C to +45 °C
Protection class	IP44
Material	VA 1.4301
Material thickness	2 mm

3 Installation

3.1 Demands on Location of eLight

**DANGER !****Safety note on a hazard with electrical voltage**

Pay attention to a proper installation. Non-observance of the requirements leads to a danger with electric voltage.

The electrify eLight is for outdoor and indoor use designed. For the installation of the outdoor light / socket, regulations regarding the location of installation must be ensured. Only in this way safe operation can be guaranteed.

Im Folgenden werden zu erfüllenden Anforderungen dargestellt:

- No installation in vulnerable areas with a high risk of flooding.
- No installation in vulnerable areas with a risk of explosion.
- Enough distance to other technical equipment.
- No direct spray water.
- Ambient temperature between -25 °C and 45 °C (-13°F and 113°F).

For installation of low-voltage systems, the specifications IEC 60364-1 and IEC 60364-5-52 must be complied.

- In order to withstand mechanical stresses, the mounting surface must be designed
- with sufficient strength.
- Make sure that the power supply is sufficiently dimensioned. Note that the sizing does not exceed the slot of the cable routing of the socket. (Information on power connection: see technical data)

**NOTE !****Important information and special features**

Avoid a confusing installation site to prevent unnecessary damage to the charging station.

3.2 Assembly of eLight



DANGER !

Safety note on a hazard with electrical voltage

Make sure that the supply line is de-energized at the time of installation. Failure to observe the safety instructions can lead to a risk of death due to electrical voltage.

The electrify eLight should only be installed by qualified personnel. Please refer to the respective subchapters for the respective assembly steps. **Make sure that the supply line is de-energized at the time of the assembly!!**

3.2.1 Assembly with ground anchor

The eLight is already preassembled in the factory. To assemble the outdoor light / socket in combination with the ground anchor, proceed as follows:

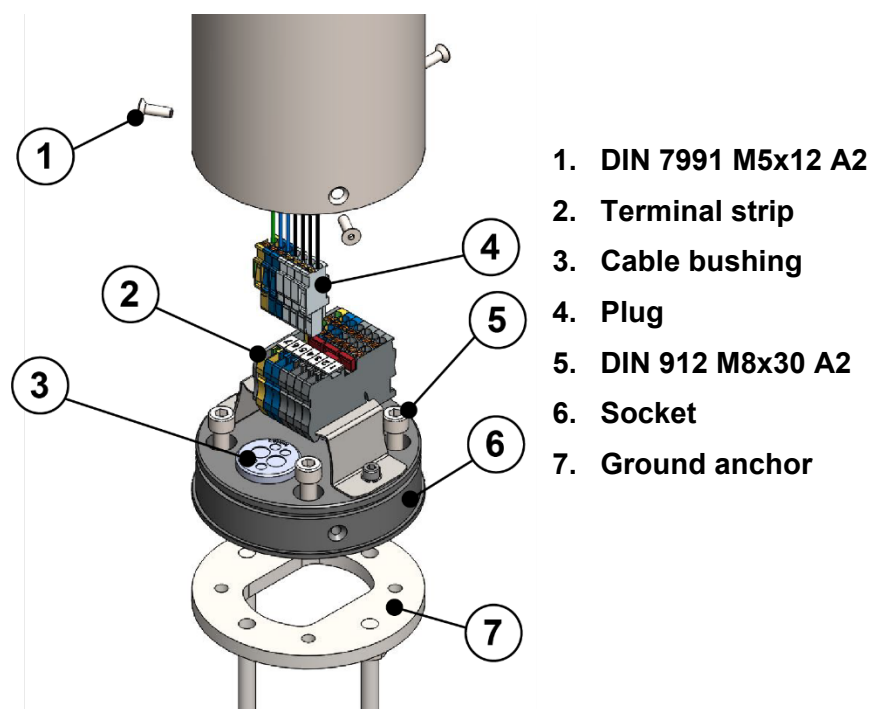

Montage in Kombination mit Bodenanker

1. First loosen the 3 side screws at the lower end of the eLight.
(similar to DIN 7991 M5x12 A2)
2. Then carefully pull the black base out of the housing.
3. Guide the supply line through the cable gland of the base and screw it to the ground anchor with the screws included in the scope of delivery.
(DIN 912 M8x30 A2)

4. Before screwing the charging station to the base, read the chapter „3.3 Electric installation of the eLight“.
5. After the successful electrical installation, place the charging post on the base and screw it with the 3 lateral screws. **(similar to DIN 7991 M5x12 A2)**

3.2.2 Assembly on an alternative Ground

The electrify eLight is already preassembled in the factory. To install the outdoor light / socket on an alternative ground, proceed as follows

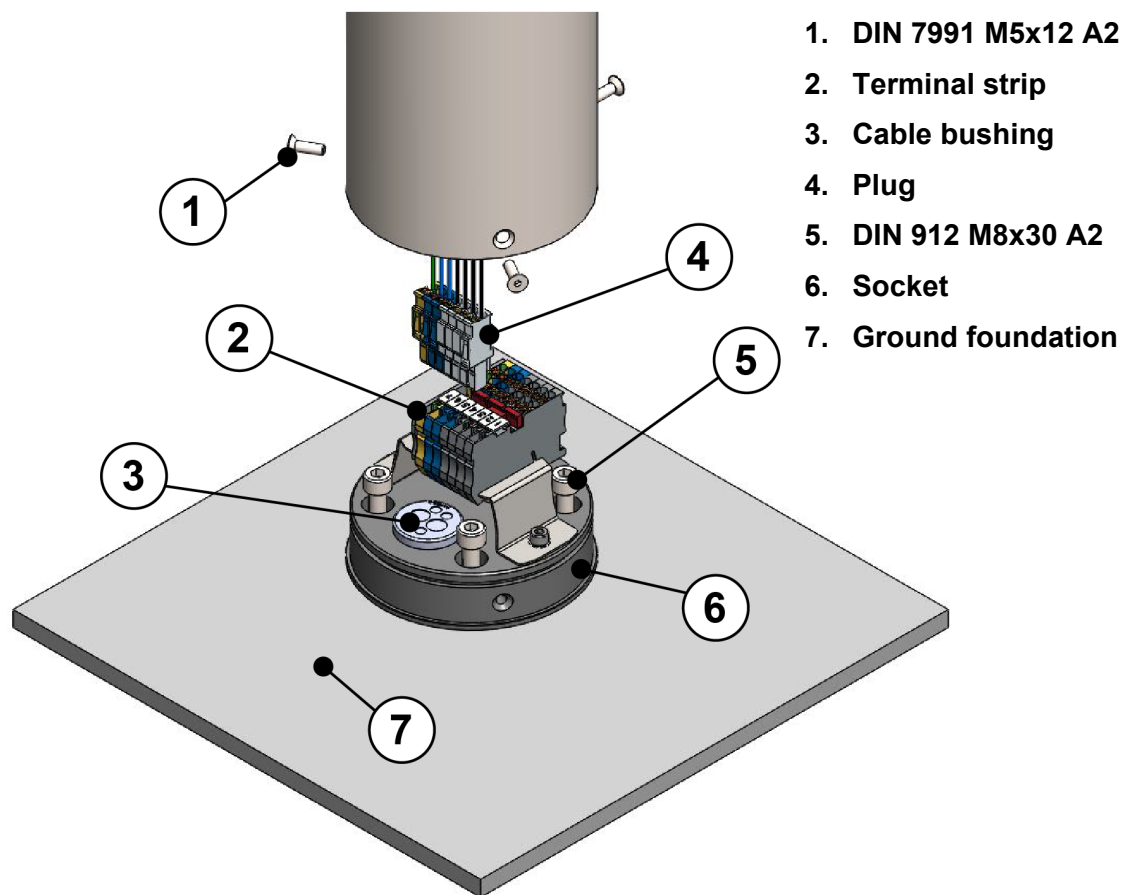

Installation on alternative ground

1. First loosen the 3 side screws at the lower end of the eLight.
(similar to DIN 7991 M5x12 A2)
2. Then carefully pull the black base out of the housing.
3. Place the base on the existing floor foundation and level it.
4. Mark the attachment points of the base to the foundation.
5. Drill the previously marked holes (**ø 10 mm**). Use the supplied assembly set for fastening. Make sure that the fastening dowels are sunk into the foundation and do not protrude above it.

6. Guide the supply line through the cable bushing of the base and screw it down with the screws included in the scope of delivery.

(DIN 912 M8x70 A2)

6. Before screwing the charging station to the base, read the chapter „3.3 Electric installation of the eLight“.
7. After the successful electrical installation, place the charging post on the base and screw it with the 3 lateral screws. **(similar to DIN 7991 M5x12 A2)**





ATTENTION !

Safety information on a hazard

Make sure that the ground foundation has sufficient strength. Failure to follow the instructions may result in damage to the device itself or to other consumers.

3.3 Electrical Installation of the eLight

	<p>DANGER !</p> <p>Safety note on a hazard with electrical voltage</p> <p>Make sure that the cables are de-energized at the time of installation. Failure to follow the instructions may result in a risk of death due to electrical voltage.</p>
	<p>ATTENTION!</p> <p>Safety information on a hazard</p> <p>Failure to follow the instructions may result in damage to the device itself or other consumers. Execution with special care!</p>

The electrical installation of the charging station may only be carried out by qualified personnel. When installing the electrical system, make sure that the cables are not damaged or crushed. These could interfere with the functions in later use, cause defects or even cause a fire.

The following table shows the connection diagram of the connection point between the ground side supply line and the eLight cables including the functional description

Supply Line Ground	Terminal Strip	eLight	
Function	Label	Color	Function
Phase	1	black	Lighting
Phase	2	black	Socket 1 (Above)
Phase	3	black	Socket 2 (Center)
Phase	4	black	Socket 3 (Below)
Neutral conductor	5	blue	Neutral conductor lighting
Neutral conductor	6	blue	Neutral conductor sockets
Protective conductor	7	green/yellow	Protective conductor

Connection diagram terminal strip eLight

	<p>NOTE !</p> <p>Important information and special features</p> <p>Slots 1-4 & 5-6 bridged together. If required, the jumpers can be removed for separate control.</p>
---	--

3.3.1 Connection description eLight variants

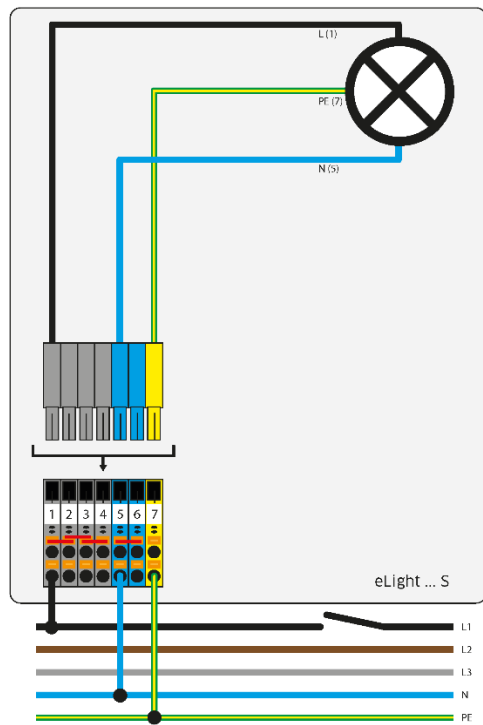

Connection diagram eLight S

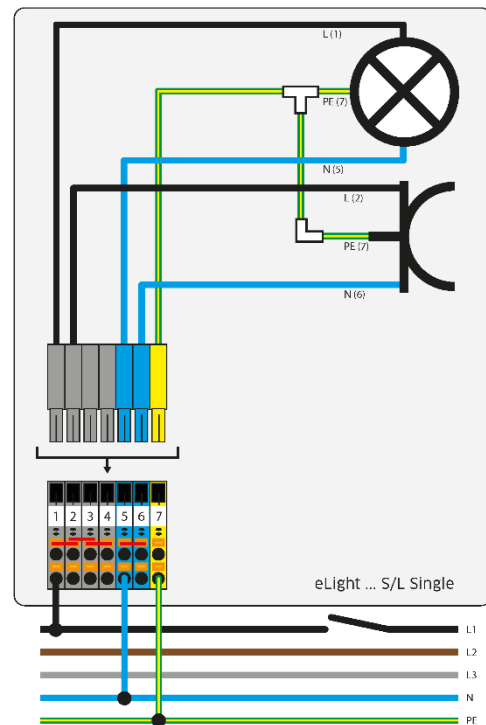

Connection diagram eLight-S-L-Single

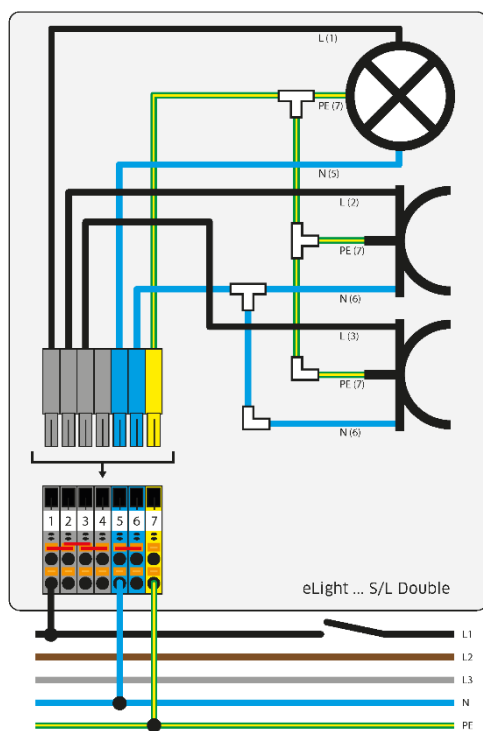

Connection diagram eLight-S-L-Double

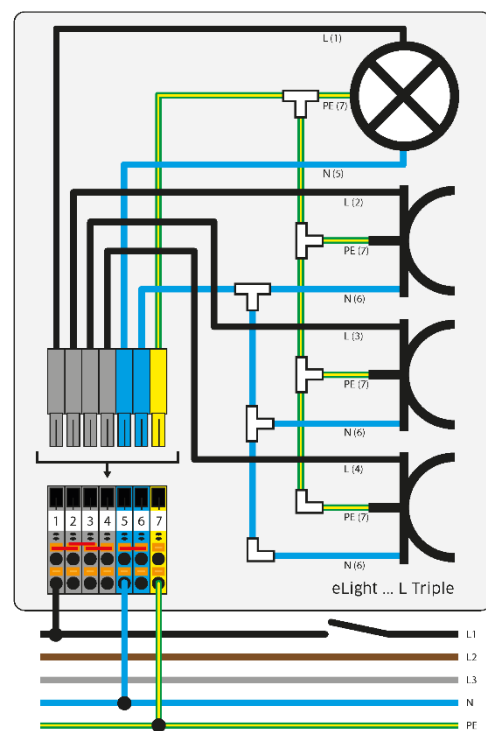

Connection diagram eLight-S-L-Triple

3.3.2 Electrical Installation of the Outdoor light / socket

The electrify outdoor light / socket is already preassembled in the factory and wired electronically. All you have to do is connect the supply line to the connection socket.

For the electrical installation of the charging station, proceed as follows:

1. Connect the cable coming from the ground to the terminal strip according to the terminal label. **(1,2,3,4,5,6,7)**
2. Insert the plug coming in from the charging station into the terminal strip.

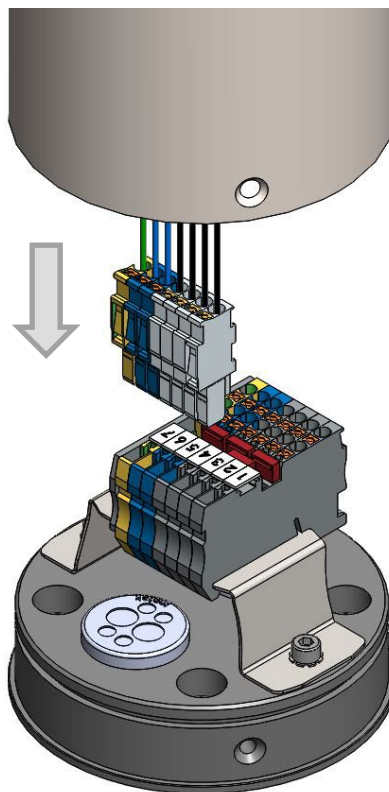

Wiring the eLight

4 Operation

The following graphic shows the main operating elements of the eLight:

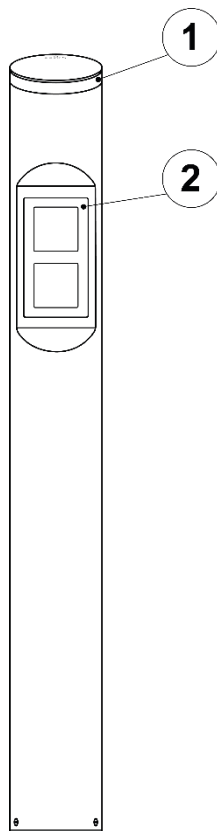

1. Illumination
2. Socket
with hinged cover

Operating elements of the eLight

5 Change illuminant

The outdoor light / socket eLight is already delivered with an integrated E27 illuminant. This can be replaced if necessary.



DANGER !

Safety note on a hazard with electrical voltage

Make sure that the cables are de-energised at the time of replacement.

To replace the illuminant in the eLight, proceed as follows:

1. Loosen the grub screw at the top of the eLight.
2. Then carefully remove the light unit.

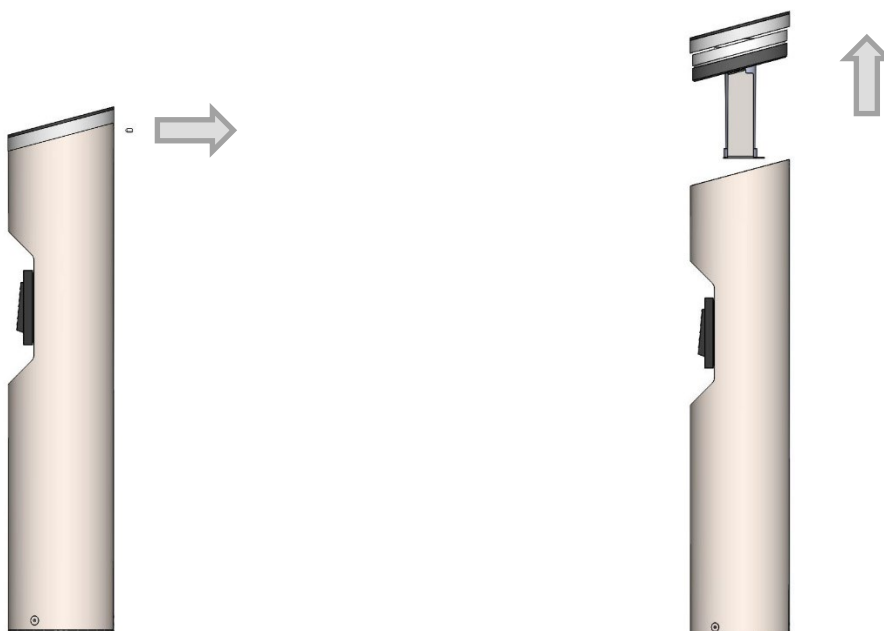

3. Now replace the illuminant and reassemble everything in reverse order.



NOTE !

Important information and special features

To ensure a tight seal, a high compressive force is required for assembly. We recommend a firm base.

6 Repair work



DANGER !

Safety note on a hazard with electrical voltage

Make sure that the cables are de-energized at the time of repair. Non-observance of the safety instructions can lead to a risk of mortal danger due to electrical voltage.

Repairs to the charging station may only be carried out by a qualified specialist. It should be noted that only spare parts released by hesotec electrify are permissible. If necessary, contact the manufacturer.

7 Maintenance / Disposal



DANGER !

Safety note on a hazard with electrical voltage

Make sure that the cables are de-energized at the time of maintenance. Non-observance of the safety instructions can lead to a risk of mortal danger due to electrical voltage.

The eLight outdoor light / socket from hesotec electrify are designed so that they are generally maintenance-free. Nevertheless, visual inspections should be carried out at regular intervals.

7.1 Maintenance

hesotec electrify recommends carrying out a test at intervals of 6 months.

- **Outdoor light / socket**

- Check the eLight for visual damage and defects.
- Check the functionality of the socket.
- Check whether there is any damage to the hinged cover.
- Check the stability of the eLight on the ground anchor/foundation.

7.2 Disposal

Old electronic devices must be disposed according to the current guidelines and disposal regulations of the respective location. Disposal with household waste is strictly prohibited! Only uses a collection point intended for electronic waste or dispose it through a specialist retailer.

The disposal of the packaging material can take place via collection points for paper and plastics.

8 Appendix

8.1 CE-Label and Declaration of Conformity

The eLight outdoor light / socket of hesotec electrify is marked with a CE label. A copy of the Declaration of Conformity will be presented later. On request, this is available from hesotec electrify gmbh.

ZERTIFIKAT / CERTIFICATE



CE - KONFORMITÄTSERKLÄRUNG CE - DECLARATION OF CONFORMITY

Hersteller manufacturer	hesotec gmbh Rubbetskath 34 46539 Dinslaken / Germany
Produkt Product	eLight eLight
Typennummer reference number	White S Serie / White L Serie Color S Serie / Color L Serie White S series / White L series Color S series / Color L series
Die Forderungen folgender euro- päischer Richtlinien werden erfüllt In conformity with the following european directives	Niederspannungsrichtlinie 2014 / 35 / EU Low Voltage Directive 2014 / 35 / EU
Angewendete Normen (harmonisiert) applied standards (harmonized)	DIN EN IEC 60598-1: 03/2022 DIN EN IEC 60598-2-1: 11/2021 DIN VDE 0620-1: 02-2021
Jahr der CE-Kennzeichnung year of declaration	2023 2023

hesotec gmbh
Rubbetskath 34
46539 Dinslaken / Germany

Tel. +49 (0) 60105-60
Fax. +49 (0) 60105-50
electrify@hesotec.de

10.05.2023

Datum
Date

Unterschrift
signatur

Sebastian Hellmich
Sebastian Hellmich

- Geschäftsführer -
- managing director -

Diese Erklärung bescheinigt die Übereinstimmung mit den oben genannten Richtlinien und beinhaltet keine
Zusicherung von Eigenschaften. This declaration certifies the conformity to the specified directives but contains no
assurance of properties.

hesotec electrify gmbh

Rubbertsath 34

46539 Dinslaken / GER

Telefon +49(0) 2064 / 60 105 – 60

Fax +49(0) 2064 / 60 105 - 50

E-Mail electrify@hesotec.de

Web electrify.hesotec.de

hesotec
electrify